

L(P)GZ(MDL)/SGZ(MDL)

系列电机上置直联刮刀下部卸料离心机

L(P)GZ(MDL)/SGZ(MDL) Direct-linked shaft Centrifuge



L(P)GZ(MDL)/SGZ(MDL)系列电机上置直联刮刀下部卸料离心机
L(P)GZ(MDL)/SGZ(MDL) Series Motor Upper
Direct Connection Scraper Down Discharge Centrifuge

● 标准结构形式

L(P)GZ(MDL)为平板式结构, SGZ(MDL)为三足式结构, 外壳桶体与机座采用焊接式, 轴承座与机盖焊接成一体后与外壳体法兰通过螺栓联接, 机盖上设置加料管、洗涤管、视镜、观察灯、料位探测器、人孔等。

● Standard Structure Form

L(P)GZ(MDL) is platform structure, and SGZ(MDL) is three-point suspension structure. Welding are adopted between shell bucket and base plate or pedestal, bearing seat welded with lid together is connected with housing by flange and fixed by bolts. It is equipped with feeding pipe, washing pipe, sight glass, observation lamp, product level detector, man hole etc.

● 主要材料

底座、机盖采用Q235衬包不锈钢, 轴座采用铸钢衬包不锈钢, 转鼓(转鼓底为铸钢衬包不锈钢)、外壳、管道等采用不锈钢制作。

● Main Material

Classis and lid adopt Q235 lined with stainless steel, bearing seat adopts cast steel lined with stainless steel, drum (its bottom is cast steel lined with stainless steel), shell cover, pipe are all made of stainless steel.

● 标准配置

采用PLC+变频控制, 能耗制动, 接触式料位探测器, 立式防爆电机, 现场防爆操作箱, 液压组合刮刀。

● Standard Configuration

PLC plus frequency conversion control, dynamic braking, contact product level detection. Stand explosive-proof motor. Spot explosive-proof operation case. Hydraulic combined scraper.

● 材质选择

根据客户防腐需求选用相适应的材料: 316、316L、321、304、TA2、哈氏合金、衬塑、喷涂Halar等。

● Material Select

Material can be chosen according to customers' requirement of erosion proof: 316, 316L, 321, 304, TA2, Haynes alloy, lined rubber, spray halar etc.

● 参数选择

可根据客户的工艺需要提供不同参数的产品:
装料容积(装料限量)

● Parametric Selection

Different parameters of product can be supplied according to customer's art requirements.
Loading capacity(the maximum capacity)

● 配置选择

- 1.变频防爆或普通电机(恒扭矩)
- 2.气动组合刮刀
- 3.反馈制动, 普通或防爆触摸屏
- 4.振动保护、充氮保护、转速监测
- 5.含氧监测或充氮压力控制
- 6.母液出口液封
- 7.在线清洗(CIP)装置、气体辅助刮刀装置
- 8.非接触式料位探测器
- 9.残余滤饼自动清除装置(获国家专利)
- 10.其它配置要求

● Configuration

- 1.Explisive-proof frequency conversion or common motor (permanent torque).
- 2.Pneumatic assisted scraper
- 3.Regenerative braking, common or explosive-proof touching screen
- 4.Vibration protection, nitrogen protection, speed monitor
- 5.Oxygen-containing monitor or nitrogen pressure control
- 6.Liquid seal of mother liquid outlet
- 7.CIP device, gas auxiliary scraper device
- 8.Non-contact product level detector
- 9.Anchor and other demands (have owned the national patent).
- 10.Other requirements of configuration



● 主要特点

- 1.电机采用上置式, 电机通过联轴器直接与主轴连接, 避免了常规传动方式中皮带摩擦引起粉尘污染的缺陷;
- 2.离心机外壳与机座采用焊接式, 强度高、结构简单、紧凑;
- 3.采用变频调速, 起动平稳, 能有效保护电机不过载损害;
- 4.采用PLC控制, 全自动运行;
- 5.配置气体辅助刮刀可消除残余滤饼层, 提高分离效果;
- 6.L(P)GZ(MDL)配装液态阻尼减振器, 运行更平稳, 操作更方便, 无基础安装型式, 安装维护方便。

● Main characteristics

- 1.Upper setting is adopted on motor design which connects directly with main shaft by coupling, it will avoid powder pollution because of belt friction during common transmission.
- 2.Welded structure is adopted between housing and base.It has advantage of high intensity, simple and tight structure and so on.
- 3.Frequency speed regulation is adopted to ensure a stable start it can protect motor from t. overload effectively.
- 4.PLC control is adopted to ensure automatic running.
- 5.Gas assisted scrapper device is adopted to remove remnant filter cake.It can improve the effect of separation.
- 6.L(P)GZ(MDL) is equipped with liquid state damp shock absorber which can ensure stable running and convenient operation. Centrifuge adopts no basis installation, which can make installation and maintenance conveniently.

● SGZ(MDL)系列全自动刮刀下卸料离心机结构示意图

Sketch Map of SGZ(MDL) Series Automatic Scraper Down Discharging Centrifuge Structure

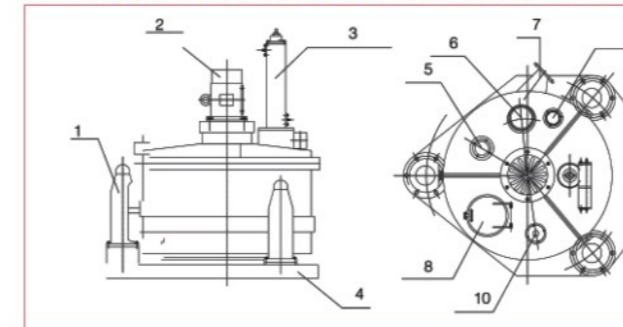

- 1.柱脚 Pedestal
- 2.电机 Motor
- 3.组合油(气)缸 Combined oil(steam) cylinder
- 4.底盘 Chassis
- 5.加料管 Feeding pipeline
- 6.视镜 Sight glass
- 7.出水管 Water outlet pipe
- 8.观察孔 Sight hole
- 9.料位探测 Material level detection
- 10.清洗管 Washing pipeline

● L(P)GZ(MDL)系列全自动刮刀下卸料离心机结构示意图

Sketch Map of L(P)GZ(MDL) Series Automatic Scraper Down Discharging Centrifuge Structure

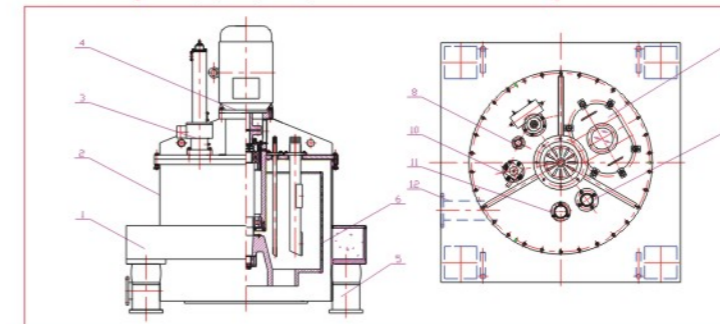

- 1.平板 Flatplate
- 2.外壳 Shell
- 3.组合油(气)缸 Oil(air)cylinder Group
- 4.电机 Motor
- 5.减振器 Shock Absorber
- 6.转鼓 Revolving Drum
- 7.人孔 Man Hole
- 8.加料管 Feeding Pipeline
- 9.清洗管 Washing Pipe
- 10.料位探测器 Level Detector
- 11.防爆灯 Explosive-proof Lamp
- 12.出水管 Water Outlet

● 型号及主要技术参数 Model and Main Parameters

项目 Item	型号 Model	SGZ-1250MDL	SGZ-1500MDL	SGZ-1600MDL	L(P)GZ-1250MDL	L(P)GZ-1500MDL	L(P)GZ-1600MDL	L(P)GZ-1600MDL(A)
转鼓直径 Drum diameter(mm)		1250	1500	1600	1250	1500	1600	1600
转鼓高度 Drum Height(mm)		630/800	700	920	630/800	800	920	1000
转鼓容积 Drum volume(L)		350/450	500	970	350/450	580	970	1000
装料限量 Loading capacity(Kg)		460/580	650	1300	460/580	720	1200	1300
电机额定转速 (rpm)		970	850	850	970	850	850	850
最大分离因素 Maximum separating factor		657	605	646	657	605	646	646
电机功率 Motor power (Kw)		22/30	37	45	22/30	37	45	45
外形尺寸(含减振器) Size Including shock absorber (mm)		2003x1780x2600	2700x2500	2700x2500	2000x2000x2266	2500x2500	2500x2500	2500x2500
机器重量 Weight(Kg)		5000/5200	9200	11500	5800/6000	12200	13300	13700

随着科技的进步, 我们保留更改的权利 All right is reserved for amendment with improvement of technology